

REV	DESCRIPTION	DATE	BY
-	INITIAL DRAWING RELEASE	12/28/2023	SMK

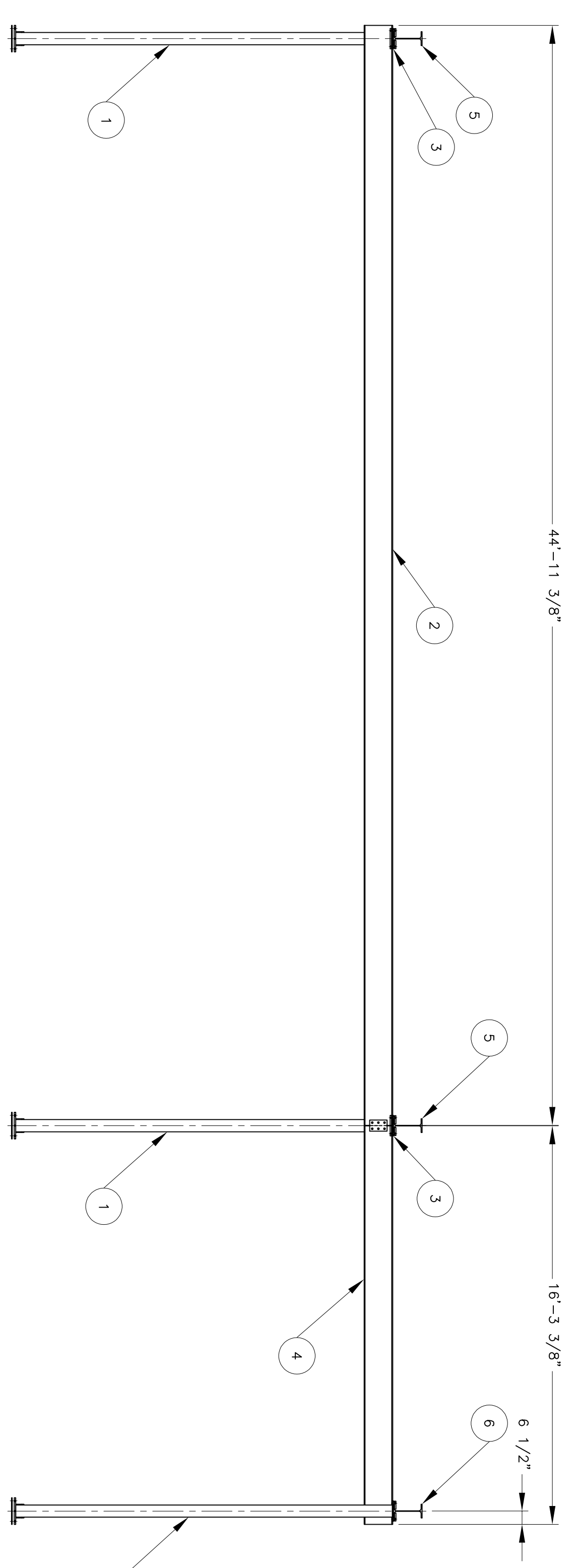
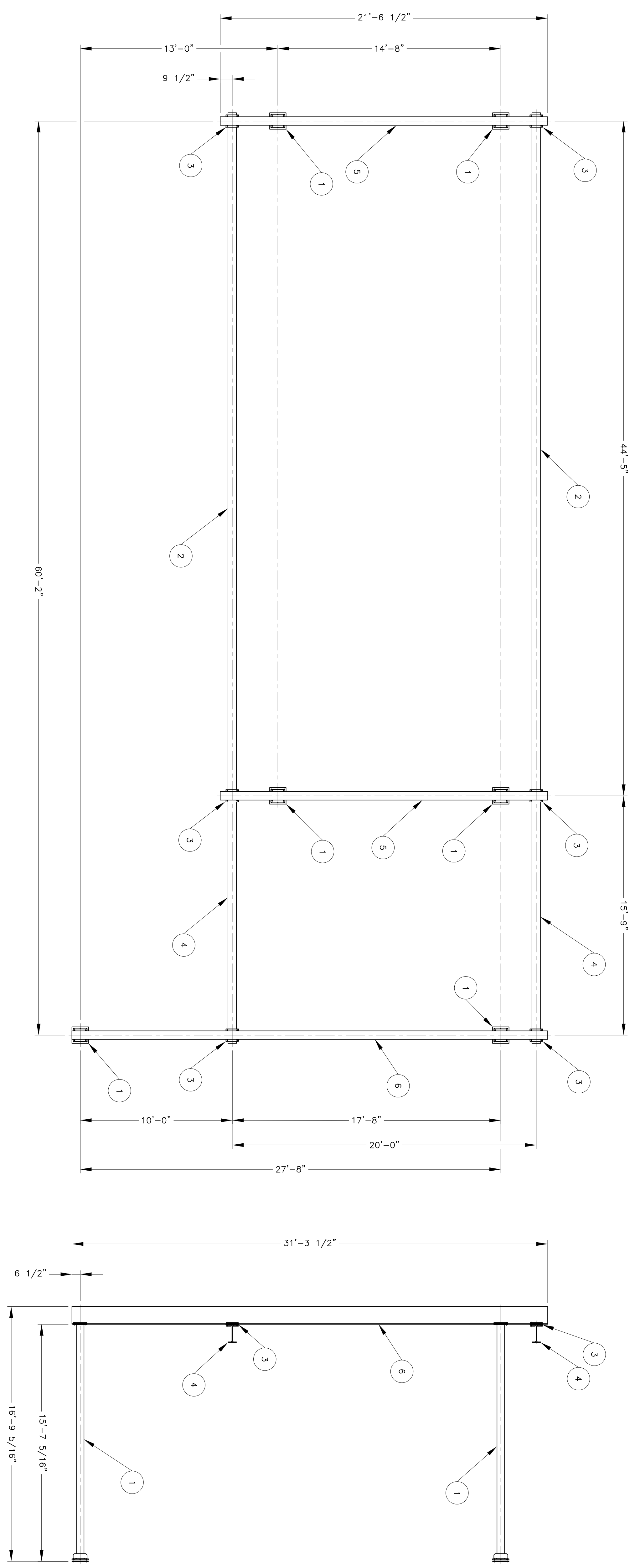

(1) REQ'D LH DOOR LOAD & LID GEO S1 FREE STAND ASSEMBLY 71704-D01A

- NOTES:
1. THE CONTRACTOR SHALL CONDUCT ALL OPERATIONS IN STRICT ACCORDANCE WITH THE SAFETY REQUIREMENTS IMPOSED BY THE OWNER AND OSHA. IT IS SOLELY THE CONTRACTOR'S RESPONSIBILITY TO FOLLOW ALL APPLICABLE SAFETY CODES AND REGULATIONS GOVERNING THIS STRUCTURE IS DESIGNED TO BE SELF-SUPPORTING AND STABLE AFTER IT IS FULLY COMPLETED. IT IS SOLELY THE CONTRACTOR'S RESPONSIBILITY TO DETERMINE ERECTION PROCEDURES AND SEQUENCES, AND TO ENSURE THE STABILITY OF THE STRUCTURE AND ITS COMPONENT PARTS, AND THE ADEQUACY OF TEMPORARY OR INCOMPLETE CONNECTIONS, DURING ERECTION. THIS INCLUDES THE ADDITION OF WHATEVER TEMPORARY BRACING, GUYS, OR TIE-DOWNS THAT MIGHT BE NECESSARY. SUCH MATERIAL IS NOT SHOWN ON DRAWINGS. IF APPLIED, THEY SHALL BE REMOVED AS CONDITIONS PERMIT, AND SHALL REMAIN THE PROPERTY OF THE CONTRACTOR.
  2. ENGINEERING DRAWINGS: ALL DEVIATIONS FROM THE ENGINEERING DRAWINGS SHALL BE SUBMITTED IN WRITTEN FORM TO THE OWNER OR THEIR REPRESENTATIVE FOR APPROVAL.
  3. STRUCTURE RATED LOAD 1250 LBS.
  4. DUAL GIRDER BRIDGE HAS A RATED LOAD OF 750 LBS.
  5. SINGLE GIRDER BRIDGE HAS A RATED LOAD OF 750 LBS.
  6. SYSTEM WEIGHT 971 LBS.
  7. ALL STRUCTURAL HARDWARE IS TO BE TIGHTENED USING "TURN-OF-NUT" METHOD PER "AISC-SPECIFICATION FOR STRUCTURAL JOINTS USING HIGH STRENGTH BOLTS".
  8. ALL BAR & PLATE DETAILS TO BE A36.
  9. ALL W SHAPES TO BE ASTM A992 (FY=50 KSI).
  10. ALL HSS TUBE TO BE A500 GR. B (FY=48 KSI).
  11. ALL BEAMS AND COLUMNS ARE CONNECTED WITH 3/4" STRUCTURAL HARDWARE.
  12. ALL U/I FABRICATED BEAM CLAMPS HAVE 3/4" STRUCTURAL HARDWARE.
  13. THE MINIMUM COLUMN ANCHOR REQUIREMENT IS A 63/4" WITH 5" EMBEDMENT.
  14. FLOOR SPACE SHALL BE A MINIMUM OF 3" THICK, 3000 PSI CONCRETE. NO CONTROL JOINTS ARE ALLOWED WITHIN 24" OF BASE FLANGE CENTER LINES.

ITEM	QTY	DESCRIPTION	PART NO.
6	1	BEAM 71704-D02E	71704D02
5	2	BEAM 71704-D02D	71704D02
4	2	BEAM 71704-D02C	71704D02
3	6	BEAM CLAMP W/4x3/4"W/4x3/4" PERPENDICULAR 71704-D03A	71704D03
2	2	BEAM 71704-D02B	71704D02
1	6	COLUMN 71704-D02A	71704D02

UNLESS OTHERWISE NOTED:  
 X = ±0.030 FRACTIONS = ±1/16"  
 XX = ±0.010 ANGLES = ±1°/30"  
 .XXX = 1.005  
 \*BREAK ALL SHARP EDGES WITH COR MAXIMUM  
 DO NOT SCALE DRAWING

APPROVALS

DATE	DATE
12/28/2023	12/28/2023
12/28/2023	12/28/2023
12/28/2023	12/28/2023

DRAWN: *SMK*  
 CHECKED: *SMK*  
 ENGR: *SMK*

TITLE  
 RHINO ASSEMBLY CORPORATION/VOLVO  
 LH DOOR LOAD & LID GEO  
 S1 FREE STAND ASSEMBLY

SCALE: 1/4"=1'-0"

SHOP ORDER#	71704
SIZE	D
DWG NO.	71704D01.DWG
PART. NO.	
REF. FILE	
SHEET	3 OF 5
REV.	-

NOTICE TO PERSONS RECEIVING THIS DRAWING AND/OR TECHNICAL INFORMATION: Unified Industries Inc. claims proprietary rights in the material disclosed herein. This drawing and/or technical information is loaned for mutual assistance and is subjected to recall by Unified Industries at any time. This drawing and/or technical information is the property of Unified Industries. Without direct permission from Unified Industries to the user. Unified Industries Inc. claims proprietary rights in the material disclosed herein. This drawing and/or technical information is loaned for mutual assistance and is subjected to recall by Unified Industries at any time. This drawing and/or technical information is the property of Unified Industries.